

IKA®

RV 10 Rotary Evaporators



product
design
award

2009



Designed
to work perfectly

IKA®
100
years



RV 10 Rotary Evaporators

| | |
|----------------------------|----|
| Overview of components | 04 |
| RV 10 basic, RV 10 digital | 05 |
| RV 10 control | 06 |
| Technical data | 07 |

Accessories

| | |
|--|----|
| Overview of featured glass accessories | 08 |
| Set of glassware, protective cover | 09 |
| Condensers | 10 |
| Vapor tubes, evaporation flasks, additional accessories | 11 |
| Additional accessories, receiving flasks | 12 |
| Miscellaneous accessories | 13 |

System accessories

| | |
|--|----|
| Magnetic valves | 14 |
| Choke valve, filter, pressure regulating valve, vacuum pump | 15 |
| Vacuum pump, chillers | 16 |

| | |
|-------------------|----|
| RV 10 FLEX System | 17 |
|-------------------|----|

You can change states of aggregation. Or the way you work with them.

With the new RV 10 range of rotary evaporators, IKA® has confirmed that there is always room for improvement, even when it comes to one of the oldest of chemical processes: distillation. The RV 10 Rotary Evaporators set new standards for safety, efficiency and ease of use. Great attention is paid to the issue of safety, from the Basic version upwards. Every model features a lifting mechanism that raises the evaporator piston out of the heating bath in case of power failure. The comprehensive safety features also include interval operation, smooth start, end position recognition for the evaporator piston, and a timer function. The digital version also provides a digital temperature display and an RS 232 interface. For fully automated distillation, IKA® offers the control version complete with integrated vacuum controller, USB interface and graphical display.

5 Year warranty*

* 2 + 3 years after registering at www.ika.com/register,
glassware and wearing parts excluded



Overview of components

- 1 Vertical glassware (other options available)
- 2 Various flask sizes
- 3 Vacuum connection plus Woulf bottle
Highly solvent-resistant PTFE seal
- 4 Adjustable safety stop
- 5 Two displays for optimal view
- 6 Heating bath can be used separately
Ergonomic carrying handles on heating bath
- 7 Can be moved by 150 mm to accommodate
different flasks
- 8 Motorised height-adjustable lift
Lift raised automatically in case of power outage
- 9 Choice of angle

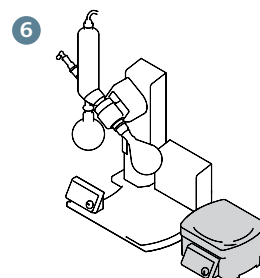

RV 10 basic and RV 10 digital

05 The basic and digital system



RV 10 basic

The RV 10 basic rotary evaporator with integrated HB 10 heating bath is the base system of IKA®'s new rotary evaporator line. The RV 10 basic is available with vertical glassware, either coated or uncoated.

- Analog heating bath with adjustable safety circuit, “stand alone” operation is possible, pivoting safety hood as an accessory
- Safe and simple operation by means of ergonomically shaped control unit in the front
- Motorized lift (stroke 140 mm) with “safety stop” function, if the power cuts out the evaporator flask is automatically lifted out of the heating bath
- Adjustable end position recognition to protect the glass from breaking
- Speed range from 20 to 280 rpm
- Smooth start from 100 rpm
- Digital speed display
- Rotates clockwise and counterclockwise in interval operation for the drying process
- Timer function for time lapse control
- Water/oil heating bath with integrated carrying handles for safe handling
- Heats up quickly because of optimised bath volumes
- Push-off mechanism to loosen tightly fitting flasks
- Suitable for DIN EN 12697-3 (Asphalt test for hot asphalt)
- 5 year warranty after registration

RV 10 basic

| Model | Description | Ident. No. |
|-----------------|---|------------|
| RV 10 basic V | with heating bath HB 10 basic and vertical glassware RV 10.1 | 8022300 |
| RV 10 basic V-C | with heating bath HB 10 basic and vertical glassware, coated RV 10.10 | 8022900 |



RV 10 digital

IKA®'s RV 10 digital is a combination of performance, reliability and versatility and offers users the precision of an accurate digitally controlled heating bath. The perfectly coordinated data transfer between the heating bath and the drive unit as well as the option of remote operation from a PC ensure results that can be reproduced any time.

Same properties as RV 10 basic, with the following additional functions:

- Digital water/oil heating bath with integrated carrying handles, “stand alone” operation is possible
- Temperature control of the heating bath by a micro controller
- Digital temperature display
- Infrared interface for data transfer from the heating bath to the drive unit
- RS 232 interface for PC remote operation with labworldsoft®
- Timer function shuts off heating bath at completion of timer sequence
- 5 year warranty after registration

RV 10 digital

| Model | Description | Ident. No. |
|--------------------|---|------------|
| RV 10 digital V | with heating bath HB 10 digital and vertical glassware RV 10.1 | 8022500 |
| RV 10 digital V-C | with heating bath HB 10 digital and vertical glassware, coated RV 10.10 | 8023100 |
| RV 10 digital FLEX | with heating bath HB 10 digital, incl. Woulff bottle | 8031500 |

! Required glassware for the FLEX package has to be ordered separately. See pages 9 - 12.

RV 10 control

The fully automated rotary evaporator

06



RV 10 control

The RV 10 control is the flagship of the new rotary evaporator series by IKA®. It offers all the functions of the RV 10 digital. But the IKA® RV 10 control goes one step further. Like the RV 10 digital, it can be precisely controlled via the RS 232 interface for remote PC operation with IKA®'s labworldsoft® and is thus ideal for automatic operation - but that's not all; the control functions also enable completely automatic distillation both for volume-based processes and full drying depending on the area of application. The expandable solvent library also allows you to incorporate new processes.

Functions and benefits

Same properties as RV 10 digital, with the following additional functions:

- Integrated vacuum controller with central display for automatic distilling and ramp programming
- Integrated solvent library, which can be extended by the user
- Distillation specific parameters stored for standard distillations
- Automatic transfer of measurements and distillation type with one key press
- Programmable volume controlled distillation
- Color graphic display for safe and comfortable operation
- Display of distillation curves
- Multiple languages
- Automatic ventilation at the end of each test
- Cooling water switched off automatically at the end of the test
- Integrated cooling water monitoring
- Heating bath safety management; automatic heating bath monitoring with distillation stop in case of temperature errors
- Heating bath switched off automatically at the end of the test
- USB interface
- 5 years warranty after registration
- **New:** Now RV 10.4002 Magnetic valve included in delivery

| RV 10 control | | |
|--------------------|--|------------|
| Model | Description | Ident. No. |
| RV 10 control V | with heating bath HB 10 control, vertical glassware RV 10.1 and RV 10.4002 Magnetic valve laboratory vacuum | 8022700 |
| RV 10 control V-C | with heating bath HB 10 control, vertical glassware, coated RV 10.10 and RV 10.4002 Magnetic valve laboratory vacuum | 8023300 |
| RV 10 control FLEX | with heating bath HB 10 control, incl. Woulff bottle and RV 10.4002 Magnetic valve laboratory vacuum | 8031600 |

! Required glassware for the FLEX package has to be ordered separately. See pages 9 - 12.

| | RV 10 basic | RV 10 digital | RV 10 control |
|---|--|--|--|
| Packages with glassware | RV 10 basic V RV 10 basic V-C | RV 10 digital V RV 10 digital V-C | RV 10 control V RV 10 control V-C |
| Cooler type | V=vertical V-C=vertical coated D=diagonal D-C=diagonal coated | V=vertical V-C=vertical coated D=diagonal D-C=diagonal coated | V=vertical V-C=vertical coated D=diagonal D-C=diagonal coated |
| Cooling surface | 1.200 cm ² | 1.200 cm ² | 1.200 cm ² |
| Drive | | | |
| Motor type | brushless DC drive motor | brushless DC drive motor | brushless DC drive motor |
| Motor rating input | 50 W | 50 W | 50 W |
| Speed range | 20 to 280 rpm | 20 to 280 rpm | 20 to 280 rpm |
| Speed display | digital | digital | digital |
| Clockwise and counter-clockwise interval operation | yes | yes | yes |
| Smooth start | yes | yes | yes |
| Head angle adjustable | 0 to 45° | 0 to 45° | 0 to 45° |
| Stroke displacement | 140 mm, motorised | 140 mm, motorised | 140 mm, motorised |
| Setting of lower end stop | 60 mm, contact-free | 60 mm, contact-free | 60 mm, contact-free |
| Vacuum controller | accessories | accessories | integrated |
| Heating bath | | | |
| Temperature range | RT to 180 °C | RT to 180 °C | RT to 180 °C |
| Heating power | 1.300 W | 1.300 W | 1.300 W |
| Controller | capillary tube controller | micro controller | micro controller |
| Temperature display | scale | digital | digital |
| Setting accuracy | scale | 1 K | 1 K |
| Control deviation | ± 5 K | ± 1 K | ± 1 K |
| Required accessories for an existing vacuum* | | | |
| In-house vacuum (industrial vacuum source for many users) |) |) | RV 10.4002 Magnetic valve ** |
| Laboratory vacuum pump (multiple connections) |) |) | RV 10.4002 Magnetic valve ** |
| Diaphragm vacuum pump (one single connection) |) |) | RV 10.4002 Magnetic valve ** |
| General data | | | |
| Dimensions without glassware (W x D x H) | 530 x 410 x 570 mm | 530 x 410 x 570 mm | 530 x 410 x 570 mm |
| RV 10 diagonal (W x D x H) | 890 x 410 x 670 mm | 890 x 410 x 670 mm | 890 x 410 x 670 mm |
| RV 10 vertical (W x D x H) | 680 x 410 x 990 mm | 680 x 410 x 990 mm | 680 x 410 x 990 mm |
| Weight of evaporator incl. heating bath without glass parts | 20 kg | 20 kg | 21,5 kg |
| Permissible ambient temperature | 5 to 40 °C | 5 to 40 °C | 5 to 40 °C |
| Protection class acc. to DIN EN 60529 | IP 20 | IP 20 | IP 20 |
| Ident. No. | | | |
| Package with vertical glassware, EU plug | 8022300 | 8022500 | 8022700 |
| Package with vertical coated glassware, EU plug | 8022900 | 8023100 | 8023300 |
| Package without glassware (FLEX) | -- | 8031500 | 8031600 |

* Will be controlled by the vacuum controller of the RV 10 control rotary evaporator.

** Magnetic valve now included with delivery of every RV 10 control.

) No accessories required for vacuum pump connection (vacuum level must be controlled by external vacuum controller).

Overview

08 Featured glass accessories

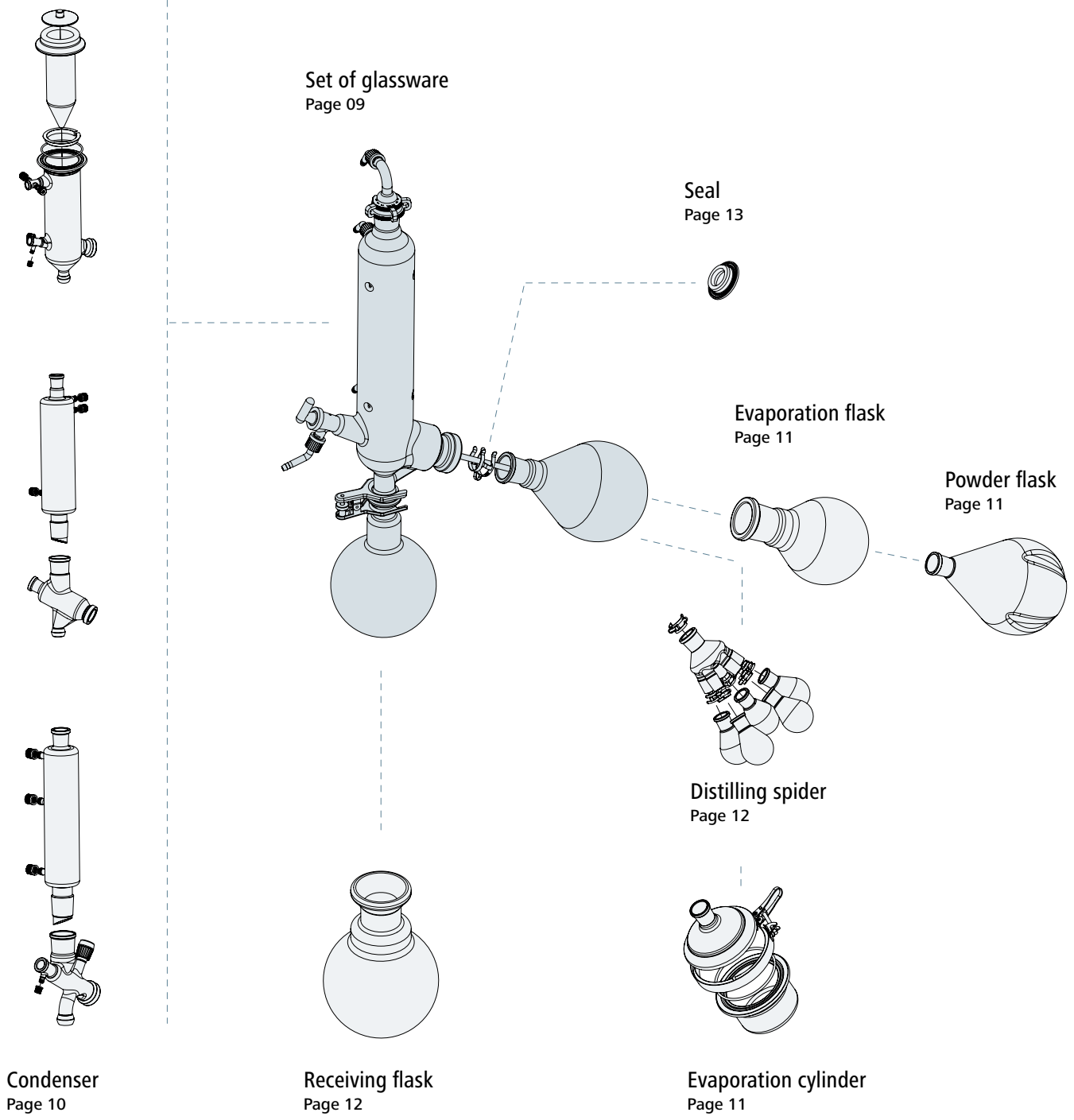

| General data | |
|-----------------|-----------------------|
| Condenser type | vertical |
| Cooling surface | 1.200 cm ² |

| Model | Ident. No. |
|---|------------|
| RV 10.1 Set of glassware, vertical | 3655300 |
| RV 10.10 Set of glassware, vertical, coated | 3755400 |

RV 10.1 Set of glassware, vertical

Compact vertical condenser for all standard distillations. The solvent to be distilled can be continuously fed in through the PTFE inlet tube.

A 1.000 ml evaporator and 1.000 ml receiving flask are included. Also available with coating. Condenser and receiving flask coated for shatter protection.

! Glassware included in all packages, except FLEX.



| General data | |
|-----------------|-----------------------|
| Condenser type | diagonal |
| Cooling surface | 1.200 cm ² |

| Model | Ident. No. |
|---|------------|
| RV 10.2 Set of glassware, diagonal | 3755300 |
| RV 10.20 Set of glassware, diagonal, coated | 3755500 |

RV 10.2 Set of glassware, diagonal

Diagonal condenser for all standard distillations. A 1.000 ml evaporator and 1.000 ml receiving flask are included. Also available with coating. Condenser and receiving flask coated for shatter protection.



| General data | |
|--------------|---------------|
| Material | Polycarbonate |

| Model | Ident. No. |
|---------------------------------------|------------|
| HB 10.1 Shield for heating bath HB 10 | 3641800 |

HB 10.1 Shield for heating bath

For optimal protection against splashes of hot liquid.



| General data | |
|--------------|---------------|
| Material | Polycarbonate |

| Model | Ident. No. |
|---|------------|
| HB 10.2 Protective cover for heating bath HB 10 | 3641000 |

HB 10.2 Protective cover for heating bath

Essential accessory if it is not possible to work in an extractor hood. Protects the user against splashes of hot liquid and in the event of the evaporator flask breaking.



RV 10 Glassware accessories



RV 10.3 Vertical-intensive condenser with manifold

Vertical-intensive condenser with double jacket and manifold for particularly efficient condensation. The solvent to be distilled can be continuously fed in at the manifold using the PTFE inlet tube. Also available with coating for shatter protection.

General data

| | |
|-----------------|-----------------------|
| Condenser type | vertical-intensive |
| Cooling surface | 1.400 cm ² |

Model Ident. No.

| | |
|---|---------|
| RV 10.3 Vertical-intensive condenser with manifold | 3741000 |
| RV 10.30 Vertical-intensive condenser with manifold, coated | 3741100 |



RV 10.4 Dry ice condenser

Dry ice condenser for distilling low-boiling point solvents. The solvent to be distilled can be continuously fed in through the PTFE inlet tube. Cooling by dry ice, no cooling water required. Max. condensation thanks to low temperatures. Also available with coating for shatter protection.

! Not possible with autodistillation mode on RV 10 control.

General data

| | |
|-----------------|---------------------|
| Condenser type | Dry ice condenser |
| Cooling surface | 620 cm ² |

Model Ident. No.

| | |
|------------------------------------|---------|
| RV 10.4 Dry ice condenser | 3742000 |
| RV 10.40 Dry ice condenser, coated | 3742100 |



RV 10.5 Vertical condenser with manifold and cut-off valve for reflux distillation

The solvent to be distilled can be continuously fed in through the PTFE inlet tube. Also available with coating for shatter protection.

! Requires RV 10.74 Vapor tube short.

General data

| | |
|-----------------|-----------------------|
| Condenser type | vertical |
| Cooling surface | 1.200 cm ² |

Model Ident. No.

| | |
|---|---------|
| RV 10.5 Vertical condenser with manifold and cut-off valve for reflux distillation | 3743000 |
| RV 10.50 Vertical condenser with manifold and cut-off valve for reflux distillation, coated | 3743100 |



RV 10.6 Vertical-intensive condenser with manifold and cut-off valve for reflux distillation

The manifold features a condensate cover and an outlet channel which prevent the condensate from coming into contact with the seal. The solvent to be distilled can be continuously fed in through the PTFE inlet tube. Also available with coating for shatter protection.

! Requires RV 10.74 Vapor tube short.

General data

| | |
|-----------------|-----------------------|
| Condenser type | vertical-intensive |
| Cooling surface | 1.400 cm ² |

Model Ident. No.

| | |
|---|---------|
| RV 10.6 Vertical-intensive condenser with manifold and cut-off valve for reflux distillation | 3744000 |
| RV 10.60 Vertical-intensive condenser with manifold and cut-off valve for reflux distillation, coated | 3744100 |

RV 10 Glassware accessories

Vapor tubes, evaporation flasks, additional accessories

| General data | |
|---------------------|--------------------|
| Material | borosilicate glass |
| Model | Ident. No. |
| RV 10.70 Vapor tube | 3812200 |

RV 10.70 Vapor tube NS 29/32

For all glassware.

! Included with each RV 10 package.



| General data | |
|---------------------|--------------------|
| Material | borosilicate glass |
| Model | Ident. No. |
| RV 10.74 Vapor tube | 3971700 |

RV 10.74 Vapor tube short NS 29/32

For vertical condensers RV 10.5 and RV 10.6.



| General data | |
|--------------------------------------|--|
| Volume (in ml) | 50, 100, 250, 500, 1.000, 2.000, 3.000 |
| Material | borosilicate glass |
| Model | Ident. No. |
| RV 10.80 Evaporation flask, 50 ml | 3740100 |
| RV 10.81 Evaporation flask, 100 ml | 3740200 |
| RV 10.82 Evaporation flask, 250 ml | 3740300 |
| RV 10.83 Evaporation flask, 500 ml | 3740400 |
| RV 10.84 Evaporation flask, 1.000 ml | 3740500 |
| RV 10.85 Evaporation flask, 2.000 ml | 3740600 |
| RV 10.86 Evaporation flask, 3.000 ml | 3740700 |

Evaporation flask NS 29/32

The flask, which is made of high quality borosilicate glass, is available in seven different sizes.



| General data | |
|----------------------------------|--------------------|
| Volume (in ml) | 500, 1.000, 2.000 |
| Material | borosilicate glass |
| Model | Ident. No. |
| RV 10.300 Powder flask, 500 ml | 3738200 |
| RV 10.301 Powder flask, 1.000 ml | 3738300 |
| RV 10.302 Powder flask, 2.000 ml | 3738400 |

Powder flask NS 29/32

The flask, which is made of high quality borosilicate glass, is available in three different sizes. The powder flask optimizes powder drying applications by avoiding the accumulation of powder on the walls of the flask and makes full use of the clockwise and counterclockwise interval rotation.



| General data | |
|--|--------------------|
| Volume (in ml) | 500, 1.500 |
| Material | borosilicate glass |
| Model | Ident. No. |
| RV 10.400 Evaporation cylinder, 500 ml | 3738800 |
| RV 10.401 Evaporation cylinder, 1.500 ml | 3738900 |

Evaporation cylinder NS 29/32

The cylinder, which is made of high quality borosilicate glass, is available in two different sizes. Makes retrieval of viscous substances easy.



RV 10 Glassware accessories

12 Additional accessories, receiving flasks



RV 10.500 Foam brake NS 29/32

The rising foam produces bursts in the glass ball extension. This stops foam from entering the receiving flask.

! Note: when using a 3 liter evaporation flask, RV 10.3000 Extension plate is required.

General data

Material borosilicate glass

Model

RV 10.500 Foam brake

Ident. No.

3739200



Distilling spider with distilling sleeves NS 29/32

For simultaneous distillation in 6, 12 or 20 distilling sleeves, included with purchase.

General data

Material borosilicate glass

Model

RV 10.600 Distilling spider with 6 distilling sleeves

Ident. No.

3739400

RV 10.601 Distilling spider with 12 distilling sleeves

3739500

RV 10.602 Distilling spider with 20 distilling sleeves

3739600

RV 10.610 Distilling sleeve, 20 ml

3919400



Distilling spider with 5 flasks NS 29/32

For simultaneous distillation in 5 evaporation flasks, included with purchase.

General data

Material borosilicate glass

Model

RV 10.606 Distilling spider with 5 flasks, 50 ml

Ident. No.

3740800

RV 10.607 Distilling spider with 5 flasks, 100 ml

3740900

RV 10.90 Evaporation flask, 50 ml

3741200

RV 10.91 Evaporation flask, 100 ml

3741300



Receiving flask KS 35/20

The flask, which is made of high quality borosilicate glass, is available in six different sizes, either coated or uncoated.

General data

Volume (in ml) 100, 250, 500, 1.000, 2.000, 3.000

Material borosilicate glass uncoated / coated

Model

RV 10.100 Receiving flask, 100 ml

Ident. No.

3742200

RV 10.101 Receiving flask, 250 ml

3742300

RV 10.102 Receiving flask, 500 ml

3742400

RV 10.103 Receiving flask, 1.000 ml

3742500

RV 10.104 Receiving flask, 2.000 ml

3742600

RV 10.105 Receiving flask, 3.000 ml

3742700

RV 10.200 Receiving flask, coated 100 ml

3743200

RV 10.201 Receiving flask, coated 250 ml

3743300

RV 10.202 Receiving flask, coated 500 ml

3743400

RV 10.203 Receiving flask, coated, 1.000 ml

3743500

RV 10.204 Receiving flask, coated, 2.000 ml

3743600

RV 10.205 Receiving flask, coated, 3.000 ml

3743700

General data

Dimensions (W x D x H) 200 x 270 x 27 mm

Model

RV 10.3000 Extension plate

Ident. No.

3859000

RV 10.3000 Extension plate

Accessories required when using RV 10.500 Foam brake.

! Note: Allows the heating bath to be moved 150 mm horizontally. Accessory required when using the RV 10.500 Foam brake and 3 liter evaporation flask.



General data

Material PTFE, stainless steel

Model

RV 10.8001 Seal

Ident. No.

3907000

RV 10.8001 Seal

New airtight lip-seal from a PTFE compound with a built-in stainless steel spring.



RV 10 System accessories

Magnetic valves

14

| | RV 10 basic | RV 10 digital | RV 10 control |
|--|-------------------|-------------------|---------------|
| Required accessories for an existing vacuum | | | |
| Magnetic valve in-house vacuum system |) |) | RV 10.4002 |
| Magnetic valve laboratory vacuum |) |) | RV 10.4002 |
| Pump control incl. magnetic valve |) |) | RV 10.4003 |
| Recommended accessories for tap water (faucet) connection | | | |
| Choke water valve | – | – | RV 10.5001 |
| Filter | – | – | RV 10.5002 |
| Pressure regulating valve | RV 10.5003 | RV 10.5003 | RV 10.5003 |
| Supplementary vacuum system | | | |
| Vacuum system | LVS 105 T - 10 ef | LVS 105 T - 10 ef | MPC 105 T |
| Additional chiller system | | | |
| for one rotary evaporator | KV 600 | KV 600 | KV 600 |
| for two rotary evaporators | UC 006 | UC 006 | UC 006 |

) no accessories required for vacuum pump connection (vacuum level must be controlled by external vacuum controller).



RV 10.4002 Magnetic valve laboratory vacuum

For a single or multiple connection benchtop diaphragm vacuum pump.

- ! Accessory required for an existing vacuum.
New: now included with each RV 10 control system

| General data | |
|---|------------|
| Power | 24 V / 9 W |
| Model | Ident. No. |
| RV 10.4002 Magnetic valve laboratory vacuum | 3880300 |
| Accessory for | |
| RV 10 control | |



RV 10.4003 Pump control incl. magnetic valve

One rotary evaporator at one pump / tabletop operation. Pump stops when the set vacuum is reached and automatically switches back on again.

- ! Accessory required for an existing vacuum. For non EU countries a plug adapter is required.

| General data | |
|--|-----------------------|
| Power magnetic valve | 24 V / 6 W |
| Power pump control | 100-240 V, 50 / 60 Hz |
| Model | Ident. No. |
| RV 10.4003 Pump control incl. magnetic valve | 3900200 |
| Accessory for | |
| RV 10 control | |

General data

| | |
|------------------------------|-------------------|
| Power | 24 V / 6 W |
| Connection diameter | 10 mm |
| Model | Ident. No. |
| RV 10.5001 Choke water valve | 3902700 |

Accessory for

■ RV 10 control

General data

| | |
|---------------------|-------------------|
| Mesh thickness | 100 µm |
| Connection diameter | 10 mm |
| Pressure | max. 11 bar |
| Model | Ident. No. |
| RV 10.5002 Filter | 3903800 |

Accessory for

■ RV 10 control

General data

| | |
|-------------------------------------|--------------------------------------|
| Connection diameter | 10 mm |
| Pressure | max. input 25 bar, max. output 1 bar |
| Model | Ident. No. |
| RV10.5003 Pressure regulating valve | 3907100 |

Accessory for

■ RV 10 basic ■ RV 10 digital ■ RV 10 control

General data

| | |
|----------------------------------|------------------------|
| Pumping speed 50/60 Hz | 1,2 m ³ / h |
| (DIN 28432 at speed of 1350 rpm) | 20 l / min |
| Ultimate vacuum | < 2,0 mbar |
| Operating pressure | 1 bar |
| Connectors for tube | ID 8 mm |
| Permissible ambient temperature | +10...+40 °C |
| Voltage | 90 - 240 V |
| Motor protection | IP 20 |
| Power | 830 W |
| Frequency | 50/60 Hz |
| Weight | 9 kg |
| Dimensions (W x D x H) | 250 x 260 x 435 mm |
| Ports | RS 232 / SUB-D 9-pole |
| Model | Ident. No. |
| LVS 105 T 10-ef | 4067800 |

Accessory for

■ RV 10 basic ■ RV 10 digital

RV 10.5001 Choke water valve

To regulate the water flow. The integrated magnetic valve closes/opens the water circuit during automatic distillation.

! Accessory recommended for tap water connection.



RV 10.5002 Filter

To prevent contamination of the water pipes. With removable filter for easy cleaning.

! Accessory recommended for tap water connection.



RV 10.5003 Pressure regulating valve

For adjusting the cooling water pressure when connecting to a tap water system.

! Accessory recommended for tap water connection.



LVS 105 T 10-ef

- Compact, dry-running, chemical resistant pump systems, the ideal solution for many applications in chemical laboratories and research
- Fully automatic pump system with built-in solvent library
- Graphic display
- Close to 100% solvent recovery
- User-friendly operation
- Optimal stability
- Quick and easy maintenance
- Equipped with a speed regulated vacuum controller and a chemical resistant diaphragm pump. The pumping speed can be precisely controlled, e.g. for gentle distillations



RV 10 System accessories

16 Vacuum pump, chillers



MPC 105 T

- For dry, oil-free applications in the low vacuum range
- Compact and space saving design
- Quiet running and long lifetime
- Easy to service and low operating costs
- Chemically resistant diaphragm pumps (MPC) are resistant to aggressive solvents and acidic vapors - diaphragms and gas contacting parts consist of PTFE and PTFE compounds and the pumping and connection heads are carbon fiber reinforced with electrical conductivity.

General data

| | |
|--|--------------------------------------|
| Pumping speed 50/60 Hz (DIN 28432 at speed of 1350 rpm) | 0,8 m ³ / h 13 l / min |
| Ultimate vacuum | < 2,0 mbar |
| Operating pressure | 1 bar |
| Connectors for tube | ID 8 mm |
| Permissible ambient temperature | +10...+40 °C |
| Voltage | 115/230 V |
| Motor protection | IP 42 |
| Power | 68 W |
| Frequency | 50/60 Hz |
| Weight | 7,5 kg |
| Dimensions (W x D x H) | 235 x 145 x 327 mm |

| Model | Ident. No. |
|-----------|------------|
| MPC 105 T | 4067700 |

Accessory for

- RV 10 control



KV 600 digital

KV 600 digital is an actively cooled chiller with an air-cooled refrigeration system, featuring a user-friendly microprocessor controller with large temperature display. The temperature accuracy is ± 1 K.

General data

| | |
|---|------------------------|
| Temperature range | -20 to 40 °C |
| Temperature display and setting | digital |
| Temperature sensor internal | PT 100 |
| Refrigerant | R134a |
| Max. delivery capacity of pressure pump | 12 l /min |
| Pump connection for hose | NW8/12 |
| Bath volume | 4 l |
| Dimensions (W x D x H) | 225 x 360 x 380 mm |
| Power supply requirement | 208 - 240 V 1 50/60 Hz |
| Min. ambient temperature | 5 °C |
| Max. ambient temperature | 32 °C |

| Model | Ident. No. |
|---------------------------------|------------|
| KV 600 digital (230 V 50/60 Hz) | 3410500 |

Accessory for

- RV 10 basic
- RV 10 digital
- RV 10 control



UC 006 Unichiller

- Chiller with air-cooled refrigerating unit and circulation pump
- Evaporator (cooler), tank, housing and pressure-suction pump made of stainless steel
- Digital temperature adjustment and digital temperature display
- Level indicator with sight glass
- Low-Cost-Controller: Modern and easy to use microprocessor controller with a large temperature display
- LED indicators for pump, cooling and heating
- Simple operation using only 3 keys

! For connecting 2 rotary evaporators to one chiller.

General data

| | |
|--------------------------------|--------------------|
| Operating temperature range | -20 to 40 °C |
| Temperature display | digital |
| Cooling power at 15°C | 0,6 kW |
| Refrigerant | R134a |
| Pump connection for hose | NW8/12 |
| Min. filling capacity | 1,25 l |
| Overall dimensions (W x D x H) | 277 x 490 x 414 mm |
| Net weight | 37 kg |
| Power supply requirement | 230 V 50/60 Hz |
| Min. ambient temperature | 5 °C |
| Max. ambient temperature | 40 °C |

| Model | Ident. No. |
|---------------------------------|------------|
| UC 006 Unichiller (230 V 50 Hz) | 3919000 |

Accessory for

- RV 10 basic
- RV 10 digital
- RV 10 control

FLEX-ability with the new IKA® RV 10 FLEX Packages

The IKA® FLEX Packages enable the customer who requires speciality glassware the FLEX-ability of customizing their glassware setup for their specific application.

| RV 10 FLEX | | |
|--------------------|---|------------|
| Package | Description | Ident. No. |
| RV 10 digital FLEX | RV 10 digital drive, HB 10 digital heating bath, RV 10.70 vapor tube NS 29/32, clamps for glassware, Woulff bottle | 8031500 |
| RV 10 control FLEX | RV 10 control drive, HB 10 control heating bath, RV 10.70 vapor tube NS 29/32, clamps for glassware, Woulff bottle, RV 10.4002 Magnetic valve laboratory vacuum | 8031600 |

Only three steps to configure your personalized rotary evaporator system:

Step 1
Choose your FLEX base model



Step 2
Select individual glassware:
- condenser
- evaporation flask
- receiving flask



Step 3
Configured RV 10 FLEX Package
with selected glassware

